



# Affordable, robust solution

## HF-Selectalume II for TL-D lamps

HF-Selectalume II is the most cost-effective, reliable, slim and affordable fluorescent solution, with highly disruptive technology for energy saving, system flexibility and unsurpassed performance. The cost-saving HF-Selectalume II has a robust design which meets all relevant international safety and performance standards. HF-Selectalume II is intended for use with indoor lighting fixtures such as spotlights, downlights and recessed luminaires, which are largely used in office, retail, industry, hotel, restaurant and other applications where control devices are installed with occasional On/Off switching activity

### Benefits

- Automatic restart (after voltage dip or lamp exchange) ensures easy operation and hassle-free re-lamping.
- DC emergency operation in line with IEC/EN 60598-2-22 luminaire norms
- Suitable for luminaires in protection class I and, after testing, class II

### Features

- Complies with CE and Kema-Keur
- Average lifetime in excess of 50,000 hours at  $T_a = 50\text{ }^{\circ}\text{C}$
- Rapid warm lamp start with filament pre-heating  $< 1.6\text{ sec}$
- Active power factor correction to ensure constant light, irrespective of mains-voltage fluctuations
- The Wago 744 connector offers the flexibility for horizontal-manual or push-in robot wiring, including a simple wire-release facility

# HF-Selectalume II for TL-D lamps

## Application

- Ideal for applications where it is necessary to reduce the wattage per square meter or operating costs
- Applications where control devices are installed with occasional On/Off switching (e.g. where movement or light sensor detectors switch the mains)
- Professional indoor applications with long operating hours such as office buildings, call centers, classrooms, hotels, department stores, retail stores, supermarkets, convenience stores and industrial premises (e.g. corridors and low-bay trunking systems) and city parking lots

## Versions



HF-S 118, 136 & 158 TL-D II, HF-S  
3/414, 3/424 TL5 II

## Dimensional drawing

A2

Product	D1	C1	A1	A2	B1
HF-S 258 TL-D II 220-240V 50/60Hz	4.1 mm	28.0 mm	280.0 mm	265.0 mm	30.0 mm

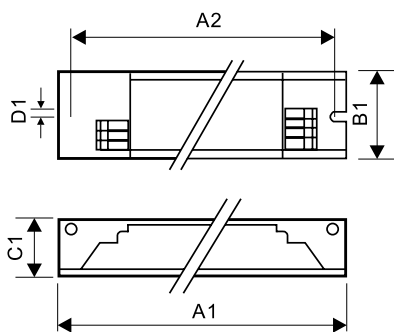

Product
HF-S 118/136 TL-D II 220-240V 50/60Hz
HF-S 218/236 TL-D II 220-240V 50/60Hz
HF-S 158 TL-D II 220-240V 50/60Hz

## HF-Selectalume II for TL-D lamps

Approval and Application	
Energy Efficiency Index	A2 BAT
Operating and Electrical	
Input Frequency	50 to 60 Hz
Input Voltage	220 to 240 V
Emergency Operation	
Emergency Ballast Lumen Factor (EBLF) (Nom)	100 %
General Information	
Lamp Type	TL-D
Mechanical and Housing	
Housing	L 280x30x28

### General Information

Order Code	Full Product Name	Number Of Products On	
		MCB (16A Type B) (Nom)	Number Of Lamps
913713032166	HF-S 118/136 TL-D II 220-240V 50/60Hz	28	1 piece/unit
913713032266	HF-S 158 TL-D II 220-240V 50/60Hz	28	1 piece/unit

Order Code	Full Product Name	Number Of Products On	
		MCB (16A Type B) (Nom)	Number Of Lamps
913713032466	HF-S 218/236 TL-D II 220-240V 50/60Hz	28	2 piece/unit
913713032566	HF-S 258 TL-D II 220-240V 50/60Hz	12	2 piece/unit

### System characteristics

Order Code	Full Product Name	Lamp		
		Power On PL-L	Lamp Power On TL-D	Rated Ballast-Lamp Power
913713032166	HF-S 118/136 TL-D II 220-240V 50/60Hz	-	35 W	36 W
913713032266	HF-S 158 TL-D II 220-240V 50/60Hz	-	49.5 W	58 W

Order Code	Full Product Name	Lamp		
		Power On PL-L	Lamp Power On TL-D	Rated Ballast-Lamp Power
913713032466	HF-S 218/236 TL-D II 220-240V 50/60Hz	61.2 W	63.9/32.9 W	36/18 W
913713032566	HF-S 258 TL-D II 220-240V 50/60Hz	-	102 W	58 W

