



# CoreLine Wall-mounted

## WL140V LED12S/840 PSU WH

Power supply unit - Symmetrical - 120° x 120°

Whether for a new building or renovation of an existing space, customers want lighting solutions that provide quality of light and substantial energy and maintenance savings. The new CoreLine Wall-mounted range of LED products can be used to replace traditional wall-mounted luminaires incorporating compact fluorescent lamps. The process of selecting, installing and maintaining is so easy – it's a simple switch.

### Product data

General Information		CE mark	CE mark
Beam angle of light source	120 °	ENEC mark	ENEC mark
Lamp colour code	840 neutral white	Warranty period	5 years
Light source replaceable	Yes	Constant light output	No
Number of gear units	1 unit	Number of products on MCB (16 A type B)	32
Driver/power unit/transformer	PSU [ Power supply unit]	Photobiological risk	Photobiological risk group 0 @ 200mm to EN62471
Driver included	Yes	Photobiological risk specification	0,2 m
Optic type	Symmetrical	EU RoHS compliant	Yes
Luminaire light beam spread	120° x 120°	Unified glare rating CEN	22
Control interface	-	<b>Light Technical</b>	
Connection	PI6 [ Push-in connector 6-pole]	Saturated Red	<50
Cable	-	<b>Operating and Electrical</b>	
Protection class IEC	Safety class II (II)	Input Voltage	220-240 V
Glow-wire test	850/30 [ Temperature 850 °C, duration 30 s]		
Flammability mark	NO [-]		

## CoreLine Wall-mounted

Input frequency	50 or 60 Hz
Initial CLO power consumption	- W
Average CLO power consumption	- W
Inrush current	14 A
Inrush time	0.007 ms
Power factor (min.)	0.9

### Controls and Dimming

Dimmable	No
----------	----

### Mechanical and Housing

Housing material	Polycarbonate
Reflector material	Polycarbonate
Optic material	Polycarbonate
Optical cover/lens material	Polycarbonate
Fixation material	-
Optical cover/lens finish	Opal
Overall height	85 mm
Overall diameter	390 mm
Colour	White RAL 9003
Dimensions (height x width x depth)	85 x NaN x NaN mm (3.3 x NaN x NaN in)

### Approval and Application

Ingress protection code	IP65 [ Dust penetration-protected, jet-proof]
Mech. impact protection code	IK10 [ 20 J vandal-resistant]

### Initial Performance (IEC Compliant)

Initial luminous flux (system flux)	1350 lm
Luminous flux tolerance	+/-10%
Initial LED luminaire efficacy	110 lm/W

Lamp colour temperature	4000 K
Colour Rendering Index	>80
Initial chromaticity	(0.3818,0.3797) SDCM <3
Initial input power	12 W
Power consumption tolerance	+/-10%

### Over Time Performance (IEC Compliant)

Control gear failure rate at median useful life	5 %
50,000 h	
Lumen maintenance at median useful life*	80
50,000 h	

### Application Conditions

Ambient temperature range	-20 to +40 °C
Performance ambient temperature Tq	25 °C
Maximum dimming level	Not applicable
Suitable for random switching	No

### Product Data

Full product code	871951452872799
Order product name	WL140V LED12S/840 PSU WH
EAN/UPC – product	8719514528727
Order code	911401847482
SAP numerator – quantity per pack	1
Numerator – packs per outer box	6
SAP material	911401847482
SAP net weight (piece)	1.890 kg



## Dimensional drawing

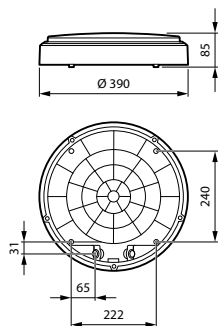

Coreline Wall-mounted WL140V

# CoreLine Wall-mounted

## Photometric data

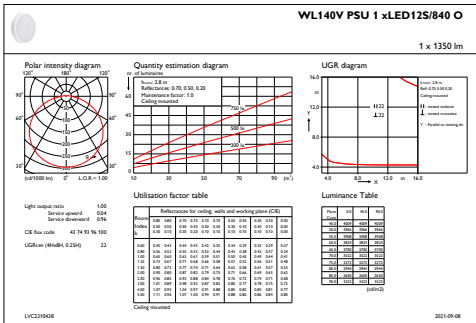

IFGU1\_WL140VPSU1xLED125S8400

